



**Archaeological Watching Brief
(Phase 2) at Court Lodge Farm,
Aldington, near Ashford, Kent
*December 2011***

SWAT. Archaeology
Swale and Thames Archaeological Survey Company
School Farm Oast, Graveney Road
Faversham, Kent
ME13 8UP
Tel: 01795 532548 or 07885 700 112
www.swatarchaeology.co.uk

**Archaeological Watching Brief (Phase 2) at
Court Lodge, Church Lane, Aldington, Ashford,
Kent**

**NGR: 607503 136284
Site Code CLF-WB-11**



**Report for
G.L. Boulden & Sons**

2011-12-29

SWAT ARCHAEOLOGY

Swale and Thames Archaeological Survey Company
The Office, School Farm Oast, Graveney Road

Faversham, Kent

ME13 8UP

Tel; 01795 532548 or 07885 700 112

Contents

1.0	SUMMARY	1
2.0	INTRODUCTION	1
	2.1 PLANNING BACKGROUND	1
	2.2 SCHEDULE OF VISITS	2
	2.3 AIMS AND OBJECTIVES	2
	2.4 PROPOSED GROUNDWORKS	2
	2.5 CONFIDENCE RATING	2
3.0	ARCHAEOLOGICAL & GEOLOGICAL BACKGROUND	2
4.0	METHODOLOGY	3
5.0	RESULTS	3
	5.1 GENERAL	3
	5.2 DEPOSIT MODEL	3
6.0	FINDS	
7.0	DISCUSSION	4
8.0	CONCLUSION	4
9.0	ACKNOWLEDGEMENTS	4
10.0	REFERENCES	4
	APPENDIX 1 - KENT COUNTY COUNCIL HER SUMMARY FORM	5
	APPENDIX 2 - GAZETEER OF ARCHAEOLOGICAL SITES	6

List of Figures

- Fig. 1 Plan of site
Plate 1. Photograph of site.
Plate 2. Photograph of site.

**Archaeological Watching Brief (Phase 2) at Court Lodge, Church Lane, Aldington,
Ashford, Kent**

NGR 607503 136284

Site Code: CLF-WB-10

1.0 SUMMARY

From 4th - 8th December 2011, Swale and Thames Archaeological Survey Company (SWAT Archaeology) carried out an Archaeological Watching Brief on the site of an extension of a grain store on land at Court Lodge Farm, Church Lane, Aldington, Kent, TN25 7EG.

The works were carried out on behalf of G.L. Boulden & Sons and consisted of excavation of made up ground to facilitate the building of a grain store extension and car parking. Planning Application Number: 10/01642/AS).

The Watching Brief revealed no archaeological features.

2.0 INTRODUCTION

2.1 Planning Background

A planning application (PAN:10/01642/AS) for the construction of a grain store extension and car parking was submitted to Ashford Borough Council. Kent County Council Heritage and Conservation (KCCHC), on behalf of Ashford Borough Council requested that an Archaeological Watching Brief be undertaken in order to record any archaeological remains uncovered during associated groundworks. The following condition was attached to the planning consent:

9. No development shall take place until the applicant, or their agents or successors in title, has secured the implementation of a watching brief to be undertaken by an archaeologist approved by the Local Planning Authority so that the excavation is observed and items of interest and finds are recorded. The watching brief shall be in accordance with a written programme and specification, which has been submitted to and approved by the Local Planning Authority.

1

2.2 Schedule of Visits

An Archaeologist attended the site and monitored excavation works on the following dates: 4th – 8th December 2011.

2.3 Aims and Objectives

The purpose of the monitoring and recording, as specified by Kent County Council was to:

'contribute to the heritage knowledge of the area through the recording of any archaeological remains exposed as a result of excavations in connection with the groundworks. (KCC 2010:1.3)

2.4 Proposed Groundworks

The groundworks involved:

- The excavation of made-up ground to facilitate the construction of a grain store extension and car park

2.5 Confidence Rating

No factors hindered the recognition of archaeological and geological deposits during the monitoring and recording exercise.

3.0 ARCHAEOLOGICAL & GEOLOGICAL BACKGROUND

The underlying geology at the site according to the British Geological Survey map is Lower Greensand of the Hythe Formation. (KCC 2011:1.7). Modern levelling deposits consisting of mid to dark brown silty clays were exposed in the excavation.

Topographically the site slopes dramatically downhill towards the northeast, and an abundance of this silty clay levelling deposit, along with ragstone rubble from a neighbouring quarry, was imported in the second half of the 20th century to create a level farmyard.

According to the County HER, the site lies c. 60m north of the remains of the 14th century Archbishop of Canterbury's Palace at Court Lodge Farmhouse, now a Grade II* building (TR 03 NE 166). The site is also c. 80m north of the Grade I listed 12th century St. Martin's Church (TR 03 NE 130). A number of listed structures on the farm include 19th century barns and cartsheds (TR 03 NE 184) c. 50m southwest of the farmhouse, early 19th century stockyards and sheds (TR 03 NE 143) c. 75m west of the farmhouse, 18th century stable/barn (TR 03 NE 86) c. 50m west of the farmhouse, and a lychgate and quadrant walls, constructed in 1904 attached to the churchyard of St Martin's (TR 03 NE 104).

4.0 METHODOLOGY

The Watching Brief was conducted in accordance with the specification compiled by Kent County Council Heritage and Conservation and it also complied with the Institute of Field Archaeologists' *Standards and Guidance for Archaeological Watching Briefs* (1999). The works comprised the observation of all groundworks, including the inspection of subsoil and natural deposits for archaeological features and finds.

5.0 RESULTS

5.1 General

Reduction of the farmyard surface by machine under archaeological supervision exposed made-up ground until some natural ragstone outcrops were revealed (Plate 2) interspersed with modern brown silty clay dumped levels. No archaeological features were recorded.

6.0 FINDS

No archaeological features present and no finds were retrieved.

7.0 DISCUSSION

The Archaeological Watching Brief carried out at Court Lodge Farm, Aldington revealed that no archaeological features were present.

8.0 CONCLUSION

The Archaeological Watching Brief has fulfilled the primary aims and objectives of the Specification. No buried archaeological features have been affected as a result of the development.

9.0 ACKNOWLEDGEMENTS

SWAT Archaeology would like to thank G.L. Boulden & Sons for commissioning the project. Thanks are also extended to Heritage and Conservation (Kent County Council).

Paul Wilkinson
Dec 2011

REFERENCES

IFA (1999) *Standards and Guidance for Archaeological Watching Briefs*

Kent County Council (2011) *Specification for an Archaeological Watching Brief at Court Lodge, Church Lane, Aldington, Kent, TN25 7EG.*

APPENDIX 1

Kent County Council SMR summary form

Site Name: Court Lodge, Church Lane, Aldington, Ashford, Kent, TN25 7EG.	
Site Code: CLF-WB-11	
Site Address:	
As above.	
Summary:	
<p>On 4th-8th Dec 2011 Swale and Thames Archaeological Survey Company (SWAT Archaeology) carried out an Archaeological Watching Brief at the above address. The works were carried out on behalf of G.L. Boulden & Sons in advance of the construction of a grain store extension(Planning Application Number: 10/01642/AS).</p> <p>The Watching Brief revealed no archaeological features.</p>	
District/Unitary: Ashford	Parish: Aldington
Period(s): N/A.	
NGR (centre of site : 8 figures): NGR 607503 136284 (NB if large or linear site give multiple NGRs)	
Type of archaeological work (delete) Watching Brief	
Date of Recording: 4 th -8 th Dec 2011	
Unit undertaking recording: Swale & Thames Archaeological Survey Co. (SWAT)	
Geology: Lower Greensand of the Hythe Formation	
Title and author of accompanying report:	
Wilkinson, P. (2011) <i>Archaeological Watching Brief at Court Lodge, Church Lane, Aldington, Ashford, Kent, TN25 7EG. (SWAT Archaeology)</i>	
Summary of fieldwork results (begin with earliest period first, add NGRs where appropriate)	
As above.	
Location of archive/finds: SWAT Archaeology	
Contact at Unit: Dr P. Wilkinson	Date: Dec2011

Appendix 2 – Gazetteer of Archaeological Sites

Period	HER Reference	Type	National Grid Reference	Description
Post Medieval	TR 03 NE 142	House	TR 0717 3601	Ruffyn's Hill Farmhouse Grade II* timber-framed farmhouse
Post Medieval	TR 03 NE 133	House	TR 0738 3613	Parsonage Farmhouse Grade II 15 th c timber-framed farmhouse
Early Medieval- Modern	TR 03 NE 130	Church	TR 0749 3618	Grade I Church of St Martin including Saxo-Norman evidence in nave and chancel
Post Medieval	TR 03 NE 128	House	TR 0750 3647	Hogben House Grade II timber-framed farmhouse
Post Medieval	TR 03 NE 127	House	TR 0749 3633	Street Farmhouse Grade II 18 th c timber-framed house
Post Medieval	TR 03 NE 182	House	TR 0756 3631	Tickner Cottage Grade II 16 th c timber-framed house

Period	HER Reference	Type	National Grid Reference	Description
Post Medieval	TR 03 NE 153	House	TR 0753 3641	Church Hill Cottage Grade II 18 th c house
Post Medieval	TR 03 NE 87	House	TR 0751 3635	St. Martin's Cottage Grade II 18 th c house
Post Medieval	TR 03 NE 184	Farm Buildings	TR 0745 3619	Barn and Cart Sheds Grade II 17 th c ragstone farm buildings at Court Lodge Farm
Post Medieval	TR 03 NE 143	Farm Buildings/structures	TR 0745 3627	Stockyard and Sheds Grade II 19 th c ragstone stock yard and sheds
Post Medieval	TR 03 NE 194	Find Spot	TR 07 36	Iron Age bronze coin Cantii/DUBNOK
Post Medieval	TR 03 NE 113	House	TR 0754 3632	Church Farmhouse Grade II 15 th c– 16 th c timber-framed Wealden house
Medieval-Post Medieval	TR 03 NE 166	House	TR 0752 3620	Court Lodge Farmhouse Grade II* farmhouse incorporating remains of Archiepiscopal hunting lodge (3 – 4 Gothic windows)

FIGURES

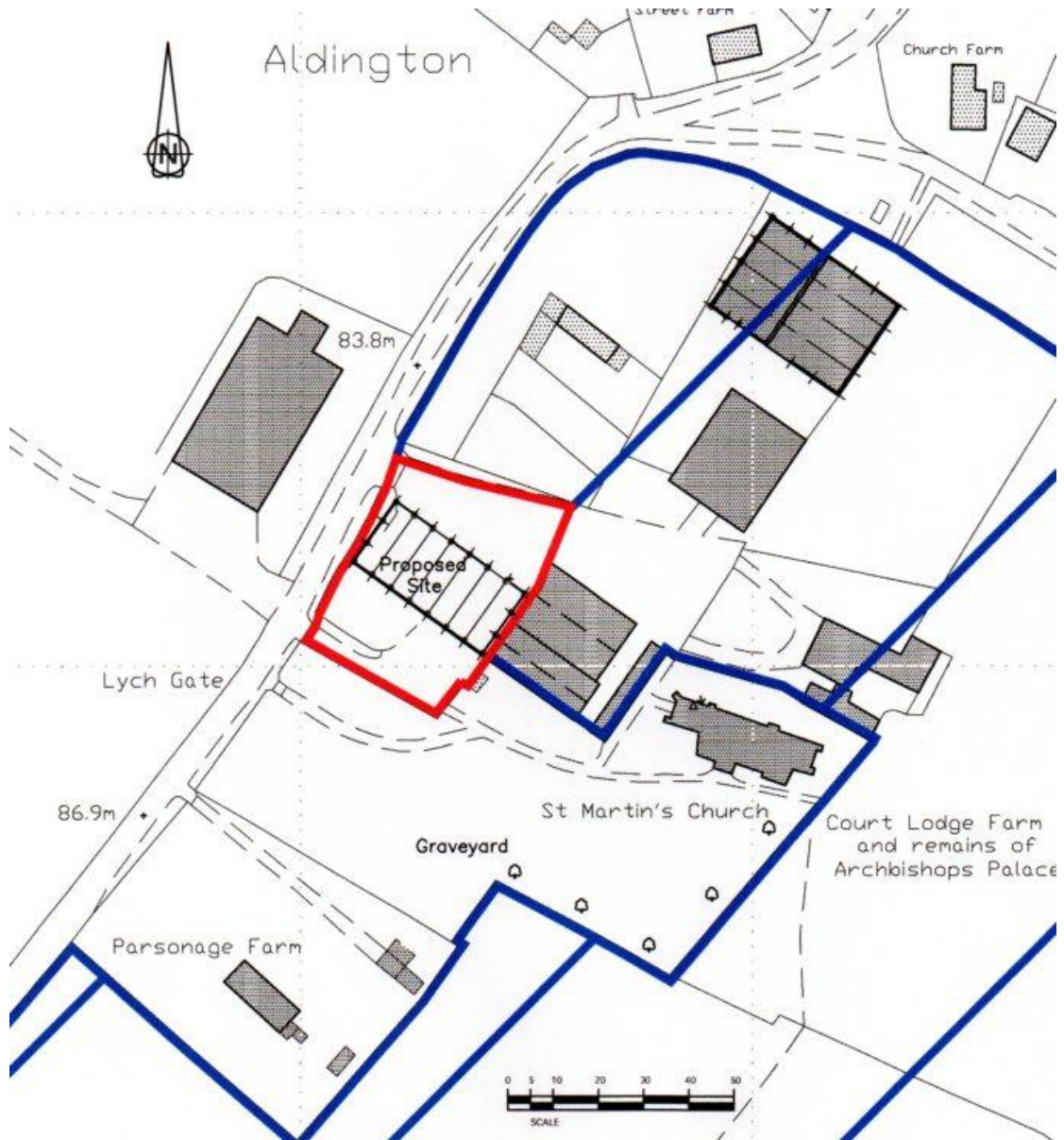

Fig. 1 Location of site of proposed development.

PLATES



Plate 1. Showing removal of made-up ground (south-west)



Plate 2. Showing view towards the church (south-east)